

**PLAN FOR PROPOSED G+III STORED RESIDENTIAL BUILDING AT PREMISES NO.- 189, KABI GURU SARANI, WARD NO. - 118, BOROUGH - XIII, U/ S. 393 (A). OF K.M.C. ACT. 1980. ALONG WITH THE K.M.C. BUILDING RULE 2009**

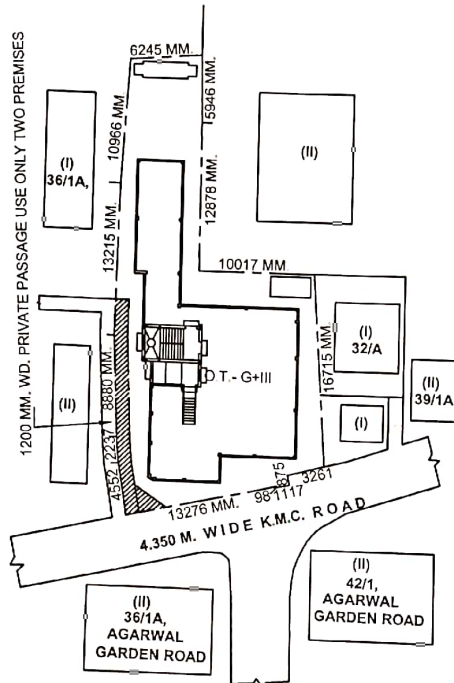

**SITE PLAN**  
SCALE = 1:600

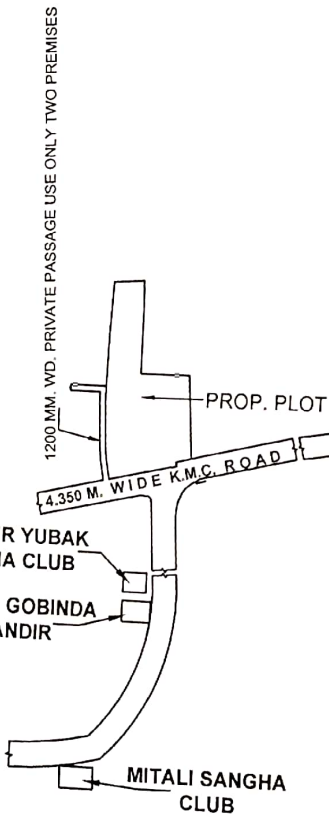
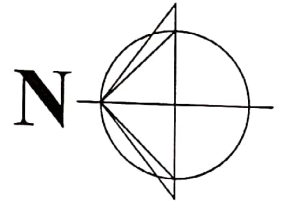

**LOCATION PLAN**  
SCALE : 1 : 4000

**UST Construction**  
*Vaishnavi*  
**Partner**